



# W T Knowles & Sons Limited











Clay Pipe & Chimney Pot Manufacturers

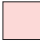

BS EN 295-1  
BS65

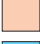
## Product Guide

# Product Key

 Pipes, Bends, Junctions, Saddles & Stoppers	 Stop Tap Products & Land Drains
 Tapers	 Thin Wall Products
 Access Junctions	 Channels & Channel Junctions
 Round Gullies & Interceptors	 Miscellaneous
 Syphons, Valves, Dishes & Anti-Flood	 Grates, Plates & Covers
 Hoppers	 Path Edging
 Gullies, Raising Pieces & Buckets	

Drainage products available from 75mm (3") to 450mm (18") internal diameter.

<b>Standard Pipe</b> 	<b>Loose Collars</b> 	<b>Double Socket</b> 
<b>Rest Bends</b> 	<b>90° Bend or 1/4 Circle</b> 	<b>45° Bend or 1/8 Circle</b> 
<b>22.5° Bend or 1/16 Circle</b> 	<b>11.25° Bend or 1/32 Circle</b> 	<b>Single Oblique</b> 
<b>Single Square</b> 	<b>Single Curved Square</b> 	<b>Tumbling Bay Single Oblique</b> 
<b>Tumbling Bay Single Curved Square</b> 	<b>Breeches Oblique</b> 	<b>Breeches Curved Square</b> 

**Double Oblique**



**Double Square**



**Double Curved Square**



**Oblique Saddle**



**Square Saddle**



**Plain Stopper**



**Taper Pipes - reducer**



**Level Invert Taper - reducer**



**Taper Bend- reducer**



**Taper Pipes - enlarger**



**Level Invert Taper - enlarger**



**Taper Bend - enlarger**



**Access Junction - single oblique left hand**



**Access Junction - single oblique right hand**



**Access Junction - single square left hand**



**Access Junction - single square right hand**



**Access Junction - double oblique**



**Access Pipe**



**Access Bend - left hand**



**Access Bend - right hand**



**Rainwater Shoe - vertical inlet**



**Rainwater Shoe - plain**



**Raising Piece & Clay Stopper**

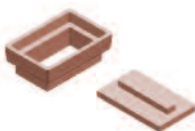

**Round Gully - NAT 138**



**Round Gully - NAT 139**



**Round Low Back Trap - NAT 148**



**Round Low Back Trap - NAT 150**



**Interceptor - with fall between inlet & outlet - NAT 130**



**Interceptor - inlet & outlet level - NAT 131**



**Kenon Interceptor - NAT 132**



**Reverse Action Interceptor - NAT 133**



**Back Bristol Interceptor - NAT 137**



**Plain Syphon - NAT 144**



**Murray's Anti-Flood Interceptor - NAT K541**



**Murray's Anti-Flood Gully**



**Block Flap Valve**



**Pipe Flap Valve**



**Dishes - Round Grate Round Outlet**

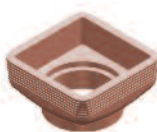

**Dishes - Square Grate Round Outlet**

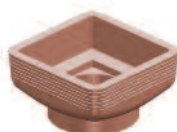

**Dishes - Round Grate Square Outlet**

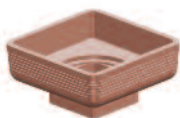

**Dishes - Oblong Round Grate Round Outlet**

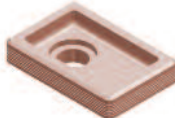

**Anti-Splash Dish Round Grate Round Outlet**



**Sheffield Combination Dish**

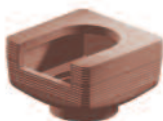

**Hull Flat Dish - Square Grate**

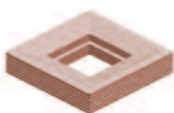

**Round Hopper**



**Round Hopper - horizontal inlet**



**Round Hopper - vertical inlet**



**Bournemouth or Manchester Top**



**Square Hopper**



**Square Hopper - horizontal inlet**



**Square Hopper - vertical inlet**



**Square Gully - P Outlet**



**Square Inspection Gully**



Gullies & Hoppers are available with various combinations of inlets

**Square to Round wash out Gully - P Outlet**



**Square to Round Inspection wash out Gully - horizontal access - NAT 191**



**Square to Round Inspection wash out Gully - vertical access - NAT 192**



**Square Gully - P Outlet horizontal socketed left hand inlet**



**Square Gully - P Outlet with horizontal plain left hand inlet**



**Square Inspection Gully - horizontal socketed left hand inlet**



**Square Inspection Gully - horizontal plain left hand inlet**



**Square Gully - P Outlet horizontal socketed back inlet**



**Square Gully - P Outlet horizontal plain back inlet**



**Square Inspection Gully -  
horizontal socketed  
back inlet**



### Square Inspection Gully - horizontal plain back inlet



**Square Gully - P Outlet  
horizontal socketed  
right hand inlet**



Square Gully - P Outlet  
horizontal plain  
right hand inlet



**Square Inspection Gully -  
horizontal socketed  
right hand inlet**



**Square Inspection Gully -  
horizontal plain right  
hand inlet**



**Square Gully - P Outlet  
horizontal socketed left  
hand and back inlets**



**Square Gully - P Outlet  
horizontal plain left hand  
and back inlets**



**Square Inspection Gully - horizontal socketed left hand and back inlets**



**Square Inspection Gully -  
horizontal plain left  
hand and back inlets**



**Square Gully - P Outlet  
horizontal socketed  
inlets opposite**



**Square Gully - P Outlet  
horizontal plain  
inlets opposite**



**Square Inspection Gully -  
horizontal socketed  
inlets opposite**



**Square Inspection Gully - horizontal plain inlets opposite**



**Square Gully - P Outlet  
horizontal socketed right  
hand and back inlets**



**Square Gully - P Outlet  
horizontal plain right  
hand and back inlets**



**Square Inspection Gully -  
Socketed right hand  
and back inlets**



**Square Inspection Gully - Plain right hand and back inlets**



**Square Gully - P Outlet  
vertical socketed  
left hand inlet**



**Square Gully - P Outlet  
vertical plain left hand inlet**



**Square Inspection Gully -  
vertical socketed  
left hand inlet**



**Square Inspection Gully - vertical plain left hand inlet**



**Square Gully - P Outlet vertical socketed back inlet**



**Square Gully - P Outlet vertical plain back inlet**



**Square Inspection Gully - vertical socketed back inlet**



**Square Inspection Gully - vertical plain back inlet**



**Square Gully - P Outlet vertical socketed right hand inlet**



**Square Gully - P Outlet vertical plain right hand inlet**



**Square Inspection Gully - vertical socketed right hand inlet**



**Square Inspection Gully - vertical plain right hand inlet**



**Round Raising Piece**



**Square Raising Piece**

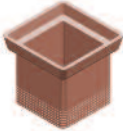

**Yard Gully**



HBI

**Semi-Universal Round Top Gully**



HBI

**Semi-Universal Square Top Gully**



**Square Mud Gully with Rodding Eye**



**Road Gully**



**Silt Bucket Round**



**Filter Bucket Round or perforated bucket without flange**



**Filter Bucket Round Flanged**



**Silt Bucket Square**

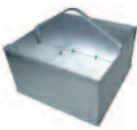

**Filter Bucket Square**





**Universal Grease Trap**



**Stop Tap Guard - BS**



**Stop Tap Guard - HU**



**Stop Tap Surface Box**

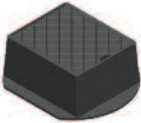

**Land Drain**



**Land Drain Junction Oblique**



**Land Drain Junction - Square**



**Land Drain Double Junction 90° Square**



**Land Drain Double Junction 45° Oblique**



**Rest Bend T.W.**



**Saddles Oblique T.W. or Plain End**



**Saddles Square T.W. or Plain End**



**Low Back P Trap T.W.**



**Square Hopper T.W.**



**Square Hopper T.W. with horizontal inlet**



**Square Gully P Outlet T.W.**



**Round Gully Flat Bottom T.W.**



**Access Gully T.W.**

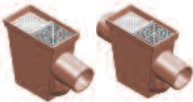

HBI

**Integral Hopper T.W.**



**Socket Adaptor T.W.**



**Channel Pipe Socketed**





**Channel Pipe Plain End  
or Manger Tube**



**Channel Taper Pipe -  
Enlarger**



**Channel Taper Pipe -  
Reducer**



**Channel Taper Bend -  
Enlarger**



**Channel Taper Bend -  
Reducer**



**Channel Bend - Left  
Hand 90° or 1/4 Circle**



**Channel Bend - Right  
Hand 90° or 1/4 Circle**



**Channel Bend - Left  
Hand 45° or 1/8 Circle**



**Channel Bend - Right  
Hand 45° or 1/8 Circle**



**Channel Bend - Left  
Hand 22.5° or 1/16 Circle**



**Channel Bend - Right Hand  
22.5° or 1/16 Circle**



**Channel Bend - Left Hand  
11.25° or 1/32 Circle**



**Channel Bend - Right Hand  
11.25° or 1/32 circle**



**Channel oddments  
available on  
request.**

**Please visit our  
website for  
further details.**

### **Manhole Construction**

Example using 1/2 section bends and/or 3/4 section bends from the left hand side

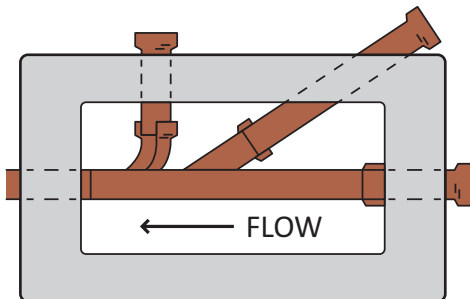

## 1/2 Section Bends

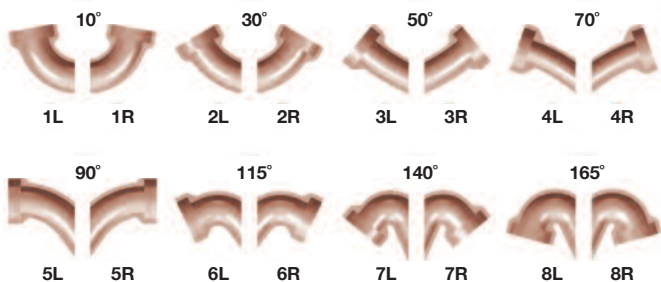

## 3/4 Section Bends

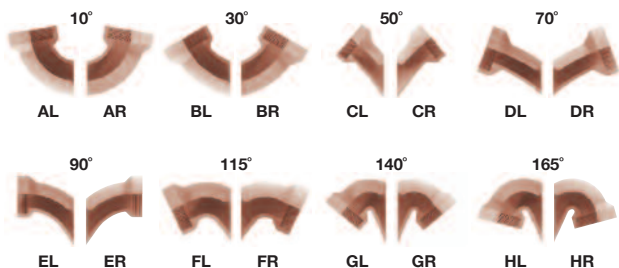

**Single Channel Junction - curved square right hand**



**Single Channel Junction - curved square left hand**



**Single Channel Junction - square right hand**



**Single Channel Junction - square left hand**



**Single Channel Junction - oblique left hand**



**Single Channel Junction - oblique right hand**



**Double Channel Junction - oblique**



**Double Channel Junction - square**



**Double Channel Junction - curved square**



**Double Channel Junction -  
breaches oblique**



**Double Channel Junction -  
breaches curved square**



**Round Gully**



**Round NE Gully**



**Times Trap**



**Flexible Standard  
Coupling**



**Flexible Adaptor  
Coupling**



**Flexible Repair  
Coupling**



**Rodding Point**



**Expanding Pip  
Stopper**



**Lever-Locking  
Stopper**



**Wine Bottle Holder**



**KWR1**

**KWR2**

**Corner Manger**



**Garden Edge Tile**



**Garden Edge Corner  
Post**



**Poultry Trough**

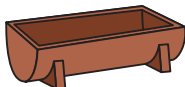

**Manger Tube Stop  
End Piece**

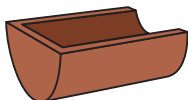

**Cattle Trough**

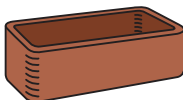

**Horse/Cattle Trough  
Stop End Piece**

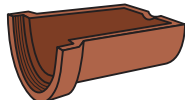

**Round Grate**



**Round Hinged Locking Grate**



**Rectangular Grate**



**Square Grate**



**Square Hinged Locking Grate**



**Hinged Gully Gate & Frame**



**Hinged Dished Top Grate & Frame Flanged 4 sides**



**Double Triangular Grate & Frame**



**Rectangular Sealing Plate**

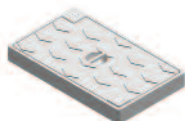

**Round Sealing Plate**



**Oval Sealing Plate**



**Square Sealing Plate**



**Double Triangular Manhole Cover**

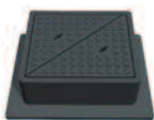

**Rectangular Manhole Cover**



**Rectangular Manhole Cover with Hand Lift**

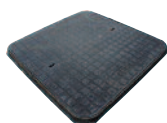

**Path Edging Channel Shallow**

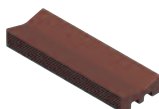

**Path Edging Channel Deep**

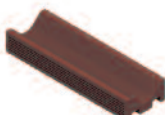

**Path Edging Channel with Drop Outlet Shallow**

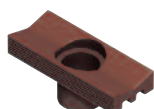

**Path Edging Channel with Drop Outlet Deep**



**Path Edging Channel Stop End Shallow**

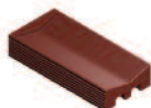

**Path Edging Channel Stop End Deep**



**Path Edging Channel  
with Stop End and  
Drop Outlet Shallow**

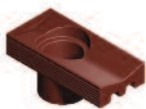

**Path Edging Channel  
with Stop End and  
Drop Outlet Deep**

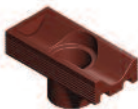

**Path Edging Channel  
TEE Shallow**

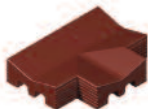

**Path Edging Channel  
TEE Deep**



**Path Edging Channel TEE  
Shallow with Drop Outlet**

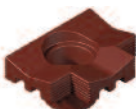

**Path Edging Channel TEE  
Deep with Drop Outlet**



**Path Edging Channel  
Bend 45° Shallow**



**Path Edging Channel  
Bend 45° Deep**



**Path Edging Channel  
Bend 90° Shallow**

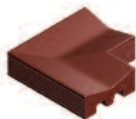

**Path Edging Channel  
Bend 90° Deep**

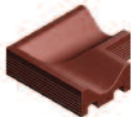

**Path Edging Channel  
Corner 90° Drop  
Outlet Shallow**

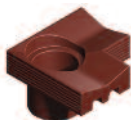

**Path Edging Channel  
Corner 90° Drop  
Outlet Deep**



**Dished Channel Block**



**Dished Channel Block  
with Drop Outlet**

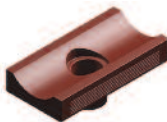

**Dished Channel  
Stop End**

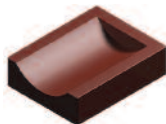

**Dished Channel Stop  
End with Drop Outlet**

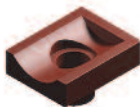

**Dished Channel  
T Junction**

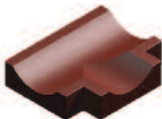

**Dished Channel T  
Junction with Drop Outlet**

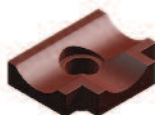

**Dished Channel 45°  
Corner Piece**

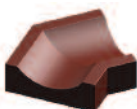

**Dished Channel 90°  
Corner Piece**

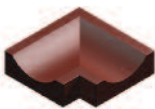

**Dished Channel Corner  
Piece with Drop Outlet**

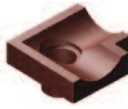



EST.



# W T Knowles & Sons

## Clay Pipe & Chimney

## W T Knowles & Sons Limited has been supporting Builders Merchants since 1906

This guide has been formatted to make identification and selection of products much more convenient and complements our website. Many variations to products are available, some of which are mentioned in this guide and our skilled Sales Staff are always available to provide advice and guidance on product selection and availability.

W T Knowles & Sons holds Kitemark Licence No. KM00348 in respect of BS 65 and Kitemark Licence No. KM201973 in respect of BS EN 295-1.

Other products (e available and can be supplied as part of a package of products.

For more detailed information about our drainage products, visit our dedicated website at [www.knowlesdrainage.co.uk](http://www.knowlesdrainage.co.uk)



## Like our product guide?

Our Chimney Pot Product Guide is also available showing our complete range of Chimney Pots.

Or visit our Chimney Pot website at [www.wtknowles.co.uk](http://www.wtknowles.co.uk)





1906

**& Sons Limited**  
y Pot Manufacturers



# Delivery across the country

#### **Delivery Charges**

Carriage is paid on orders over £450.00 Net, delivered UK mainland (excluding Scottish Highlands). Special deliveries will be charged at hauliers rates.

#### **Minimum Order Charge**

A minimum order charge of £15.00 Net will apply to all purchases whether delivered or collected.

T: 01422 372 833    E: [sales@wtknowles.co.uk](mailto:sales@wtknowles.co.uk)  
[www.wtknowles.co.uk](http://www.wtknowles.co.uk)    [www.knowledrainage.co.uk](http://www.knowledrainage.co.uk)

## Notes

.....

.....

.....

.....

.....

.....



**For more information contact us:**

**T: (+44) 01422 372833**

**F: (+44) 01422 370900**

**E: [sales@wtknowles.co.uk](mailto:sales@wtknowles.co.uk)**

***Your local distributor:***

**or visit our Website**  
**[www.knowledrainage.co.uk](http://www.knowledrainage.co.uk)**



**W T Knowles & Sons Limited**

**Clay Pipe & Chimney Pot Manufacturers**



***First Edition***